



Sundancer

390

SUNDANCER®



Regardless of your destination, this spirited performer will get you there with enough class and fashionable flair to satisfy the most demanding guest. The 390 Sundancer® delivers refined luxury with a contoured fiberglass hardtop, U-shaped cockpit seating, center walk-thru transom door, optional teak decking, and amenities galore. The helm is designed to seamlessly integrate a range of standard and optional navigational gear, and provides control of the standard Axis® or optional Zeus® propulsion system.

Some equipment shown may be optional and/or not CE-certified.
Options and colors shown may not be available on current model-year product.

390

SUNDANCER®



Picture yourself on this cozy salon sofa, curled up with a good book or watching the 26" drop-down flatscreen TV, munching on some hors d'oeuvres prepared at the galley with stainless-steel appliances. Oversized hull windows flood the cabin with natural light. It's all part of the Sea Ray® difference aboard the 390 Sundancer®.







A great host knows how to set the scene, and is prepared for unexpected guests. The 390 Sundancer® has a private master stateroom with innerspring mattress, but can sleep a total of six with convertible sofas in the salon and conversation area/mid-berth. Once again, separate head and shower compartments mean more functionality.

Interior fabric shown may not be available on current model-year product. See pages 58-59 for current details and additional interior options.





GEL-COAT OPTIONS

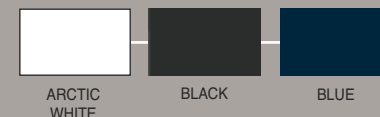

FEATURES & STANDARD EQUIPMENT

HULL & DECK FEATURES

Bottom Paint
Bow Rail, Stainless Steel
w/Welded Stanchions,
Intermediate Rails & Life Lines
Canvas Colors (Blue, Black,
Pewter)
Cleats, Custom Sea Ray® Thru-
Bolted - Stainless Steel (6)
Deck Fill Plates, Stainless Steel
Deck Rails, 316 Stainless Steel
Drain Plugs, Brass-Threaded -
Garboard
Gel Coat, Arctic White
Graphics, Striping
Handrails, 316 Stainless Steel
Hatch, Deck Vent - Translucent
w/Locks & Sky Screen Cover
(Trapezoid)
Hull Windows, Stainless Steel
(6 Fixed)
Lights, Navigation
Portlights, Stainless Steel (2
Fixed,
2 Opening)
Resin, High-Performance
Vinylester
Rub Rail, PVC w/Stainless-Steel
Insert
Storage Transom Wall (For
Fenders & Gear)
Stringer System - Fiberglass
Swim Platform, Integral
w/Concealed Stainless-Steel
Four-Step Swim Ladder
w/Integral Grab Handle
Thru-Hull Fittings, Stainless Steel
Toe Rail, Molded Fiberglass -
Deck
Vent System, Engine Room -
Integral
Windshield, Tempered/Tinted -
Curved Glass w/Stainless-Steel
Frame, Electric Front Vent &
Stainless-Steel Supports
Windshield Washer System
Windshield Wipers w/Delay &
Speed Control

Canvas (Sunbrella®):

Aft Curtain w/Bungee Cords
Aft Sunshade
Front Curtains
Side Curtains

Windlass System:

Anchor, Galvanized
Anchor Chute, Stainless Steel
Anchor Rope/Chain Storage
w/Gas-Assisted Hatch
Anchor Washdown Spigot
Windlass, Rope/Chain w/Foot
Switches

Certifications:

Meets Applicable USCG & ABYC
Standards
NMMA Certification
Mercury® Installation Quality
Certification (Gas Engines)

COCKPIT FEATURES

Beverage Holders (8)
Carpet Liner, Snap-In
Door, Cabin Entry - Acrylic
Door, Transom
Floor Liner, Fiberglass - Self-
Bailing

Handrails, 316 Stainless Steel
Hardtop, Fiberglass w/Vent Hatch,
Overhead Lighting & Aft
Sunshade
Hatch, Engine Room - Electrically
Actuated
Icemaker, 120V
Lighting, Multi-Color LED
Outlet, 12V Accessory
Outlet, 120V GFI Protected
Seating, Companion Bench
w/Molded Fiberglass Storage
Base & Euro-Style Backrest
Seating, Helm w/Flip-Up Thigh-
Rise Bolster, Armrests & Heavy-
Duty Pedestal w/Slide, Swivel &
Pneumatic Vertical Adjustment
Seating, U-Shaped Aft w/Storage
Below - Starboard
Seating, L-Shaped Aft w/Storage
Below - Port
Ship's Bell
Steps, Boarding (Molded-In)
Storage, Side Panel
Table, Cockpit w/Dedicated
Storage
Wet Bar w/Sink, Faucet Solid-
Surface Countertop, Stainless-
Steel Handrail, Trash
Receptacle & Carry-On Cooler
Storage - Port

CABIN FEATURES

Blinds, Wood
Carbon Monoxide Monitors
Carpet, Masland® 55-Ounce 100%
Stainmaster BCF Nylon
w/DuPont® Advanced Teflon
Repel System
Carpet Runners, Interior
(Sunbrella®)
Curtains & Drape Trim
Handrails, Stainless Steel
Lighting, 12V Indirect
Lighting, 12V Xenon
Outlets, 12V Accessory
Outlet, Phone
Outlets, 120V GFI Protected
Outlet & Switch Plates - Chrome
Finish
Pillows, Accent
Steps, Entryway - Wood
Storage, In-Floor
Wood Interior Finish - High Gloss
or Matte Light or Dark Cherry, or
Satin Light Rift Oak

Salon:

Entertainment Center
- Gaming System Port
- iPod® Interface w/Docking
Station
- MP3 Port w/12V Outlet
- Stereo, Sony® 12V AM/FM
Single CD, Sirius® Satellite*
Receiver w/Antenna, Amplifier,
Subwoofer, Speakers (8),
Digital Cockpit Remote Control
& Speaker Selector Switches
- TV, 26" Flatscreen LCD (120V)
Drop-Down w/Remote DVD
Player
Seating, Sofa w/Storage Below -
Converts to Bed w/Filler
Cushions (Ultraleather™)
Storage, Gunwale Cabinets
Table, Dinette w/High-Gloss Wood
Surface and Dedicated Storage

Galley:

Coffeemaker, 120V*
Countertop, Solid-Surface w/Sink,
Single Lever Faucet & Sink
Cover
Freezer, Over-Counter
w/Stainless-Steel Front - Dual
Voltage 120V/12V
Handrail, Stainless Steel
Microwave w/Stainless-Steel Front
- 120V
Power Vent, 12V w/Stainless-Steel
Grill
Refrigerator, Under-Counter
w/Stainless-Steel Front - Dual
Voltage 120V/12V
Storage, Drawers w/Cutlery Insert
Storage, Upper & Lower
w/Designated Plate & Glass
Storage
Stove, Two-Burner (Surface
Mounted) w/Pop-up Pot Holders
- 120V
Trash Receptacle w/Chute & Solid
- Surface Cover

Forward Stateroom:

Bed, Full-Size Island-Style
w/Innerspring Mattress, Pillows,
Sheets & Coordinated Spread
Door, Privacy (Sliding Pocket)
Hanging Locker w/Light & Shelf -
Starboard
Hanging Locker, Mirrored w/Light
& Shelf - Port
Mirrored Rope Locker Bulkhead
Storage, Side Shelves
TV, 15" Flatscreen w/DVD Player

Forward Head - Port:

Bathroom Tissue Holder
Doors, Privacy - Access from
Forward Stateroom & Salon
Handrails, Stainless Steel
Head, VacuFlush®
Power Vent, 12V
Robe Hook
Storage, Medicine Cabinet -
Mirrored
Vanity w/Solid-Surface
Countertop, Sink, Faucet &
Storage Below

Forward Shower - Starboard:

Curtain, Shower
Door, Privacy - Access from
Forward Stateroom
Handrail, Stainless Steel
Robe Hook
Shower w/Seat & Adjustable
Shower Wand

Mid-Berth:

Curtain, Privacy
Portlight, Stainless Steel (Fixed)
Seating, Conversation Pit -
Converts to Double Berth
w/Slide-Out Base
Storage, Cabinet - Starboard

TECHNICAL FEATURES

Control Station:

Alarms, High-Water - Bilge &
Cabin
Compass
Dash, Gel Coated - Agate
Emergency Start System -
Engines
Horns, Air (Concealed) - Dual
Trumpet
Instrument Panel, High-Gloss
Joystick, Axis Control
Power Steering, Hydraulic w/Tilt
Wheel
Shift & Throttle Controls -
Electronic (Mercruiser® DTS)
SmartCraft® Diagnostics:
- Instrumentation, Custom
Sea Ray® SmartCraft w/Low-
Glare Blue Night Lighting &
Chrome Bezels
- 4-in-1 Multigauges (2)
(Includes: Fuel Level, Oil
Pressure, Voltmeter & Water
Temperature)
- Tachometers (2)
SmartCraft VesselView Display:
- Propulsion: Engine Hour
Meters, Engine Status,
Performance and Fuel, Peak
Performance, Boost Pressure
(optional), Troll Control, Cruise
Control
- Vessel: Vessel Status, Tank
Status, Steering Position,
Generator Data
- Environment and Navigation:
GPS Interface, Depth and
Water Temperature, Depth
Alerts, Trip Log Information,
Fuel to Waypoint Data,
Navigation Data
- Active Alarms/Details
- Alarm History/Details
Switch Panel, High-Gloss (Backlit)
Switches, Illuminated
Weatherproof Rockers &
Electronic Dimmer Control

Electronics:

Electronics Circuit, 50 Amp/12V
VHF Radio, Raymarine® 240
w/Remote Speaker & 8'
Fiberglass Antenna

Electrical Systems:

Batteries, (4) w/Trays
Battery Charger/Converter,
120V/40 Amp/12V
Battery Switches, 2-Way Solenoid
Activated (MDP & Bilge)
Cable TV System w/Inlet (Includes
Phone Inlet), TV & Phone Shore
Cords, Coax Outlets, Gain
Control & Omni Directional
Antenna
Galvanic Isolators (2)
Panel, DC Circuit Breaker -
(Remote)
Panel, DC Main Breaker
Panel, Main Distribution - AC
Panel, Main Distribution - DC
Shore Power, Dual 120V/30 Amp
w/50' Cords
Wiring, Color-Coded w/Chafe
Protection

Generator:

7.3 kW Kohler® Low Emission -
Gas (120V/60 Cycle) w/Sound
Shield, Remote Start, Muffler,
Closed Cooling, Fuel Filter,
Seacock & Seawater Strainer

Air Conditioning/Heating:

Zone-Controlled Reverse-Cycle
System (18,000 BTU)
Custom Integral Vent System

Engine Room:

Bilge Pumps, 12V Automatic (2)
Bilge Pumps, 12V Automatic High-
Water (1 Bilge, 1 Cabin)
Blowers, 12V Bilge (2)
Fire Suppression System -
Automatic w/Manual Pull
Gel-Coated Engine Room
Insulation, Engine Room - 2"
w/Loaded Vinyl Barrier
Lighting, 12V
Steps, Engine Room Access

Fuel System:

Fuel Filters, Remote (Racor®
Filters for Diesel Engines)
Fuel Lines, USCG - Type A-1
Fuel Tanks, Aluminum w/Electric
Shutoff Valves (Manual Valves
for Diesel) & Ultrasonic Sending
Units

Water System:

Freshwater Washdown Spigot -
Transom
Manifold System w/Shutoff Valves
Pressure Water System w/12V
Pump & Charcoal Filtration
System
Shower, Cockpit - Single-Lever
Hot & Cold w/Stainless-Steel
Door, Braided Hose, and
Ergonomic Shower Wand
Water Heater, 120V (6-Gallon)
Water Inlet, Dockside

Waste Systems:

Head System (VacuFlush)
Holding Tank Level Indicators -
MDP & Head
Holding Tank w/Dockside Pump-
Out
Sump Box w/Pump - Automatic

FEATURES & STANDARD EQUIPMENT

STANDARD PROPULSION

MerCruiser® T-496 Magnum® DTS
Bravo® III w/Axius
(T375 php - 280kW)

OPTIONS & ACCESSORIES

Optional Propulsion

Twin Gasoline Sterndrives w/Axius®:

MerCruiser T-496 Magnum DTS
SeaCore™ Bravo III w/Axius
(T-375 php - 280 kW)

MerCruiser T-496 Magnum HO DTS
Bravo III w/Axius
(T-425 php - 317 kW)

MerCruiser T-496 Magnum HO DTS
SeaCore Bravo III w/Axius
(T-425 php - 317 kW)

Twin Gasoline V-Drives:

MerCruiser T-VD-8.1 S DTS Horizon
(T-370 php - 276 kW)

MerCruiser T-VD-8.1 S DTS HO
(T-420 php - 313 kW)

Twin Diesel Zeus® Drives:

T-Cummins MerCruiser QSB 380
DTS (T-364 php 271 kW)

Twin Diesel V-Drives:

T-VD-Yanmar® 6LP-STP
(T-306 php - 271 kW)

(SmartCraft® Systems N/A on
Yanmar Diesel Engine
Applications.)

Generator Options

8.0 kW Kohler® - w/Yanmar Diesel,
120V/60 Cycle

6.0 kW Kohler Low CO - Gas, 220V/50
Cycle (Int'l)

6.5 kW Kohler - w/Yanmar Diesel,
220V/50 Cycle (Int'l)

9.0 kW Onan® - Diesel, 120V/60 Cycle*

7.0 kW Onan - Diesel, 220V/50 Cycle
(Int'l)*

(Generator manufacturer and size may
vary due to product availability)

*w/SmartCraft® Interfacing

ELECTRONICS OPTIONS

Raymarine® Individual Options:

Raymarine E120, 12.1" Color LCD,
Radar/GPS/Chartplotter
w/Integrated 4kW Open Array
Scanner - Primary Display
Raymarine E120 GPS/Chartplotter -
Auxiliary Display
Raymarine Raypilot ST 8002
Autopilot (N/A w/Zeus® or Axius)
Raymarine DSM 300 Fishfinder
Module for E120 Display
Raymarine Sirius® Weather Module*

INDIVIDUAL OPTIONS:

Air Conditioning/Heating - Cockpit
Anchor, Stainless Steel (In Lieu of
Galvanized)
Bow Thruster (n/a w/Zeus & Axius)
Canvas, Dash Cover
Colored Hull - Blue or Black
DSS Satellite TV System
Flooring, Teak - Cockpit
Flooring, Teak - Integral Swim
Platform
Flooring, Wood (Light or Dark Maple)
- Salon & Galley
Gray Water System
Lights, Underwater - Transom (2)
Macerator w/Seacock Interlock
System
Pots & Pans, Stackable Kenyon®
Refrigerator, 120V - Cockpit (In Lieu
of Standard Icemaker)
Rod Holders (2)
Spotlight w/Dual Halogen Bulbs -
Remote Controlled
Stereo, Sound System Upgrade -
Cockpit (Speakers & Amps Only)
Sun Pad w/Adjustable Backrest -
Forward Deck
Table, High-Gloss Teak w/Vinyl
Cover - Cockpit (In Lieu of Std.
Table)
TV, 19" Flatscreen w/DVD Player -
Cockpit
TV, 15" Flatscreen w/DVD Player &
Gaming System Port - Mid-Berth
Upholstery Upgrade, Promessa
Outdoor Ultraleather™ (In Lieu of
Vinyl) - Cockpit
Vacuum System, Central, 120V
Windlass, All-Chain (In Lieu of Std.
Rope/Chain)
Windlass Capstan
Yacht Flag & Flagpole

CE Option

SPECIFICATIONS

| | | |
|--|------------|-----------|
| Overall length w/std. integral swim platform | 39' | 11.89 m |
| Beam | 12'6" | 3.81 m |
| Draft up (Axius Drives) | 26" | 67 cm |
| Draft down (Axius Drives) | 36" | 91 cm |
| Draft (inboards) | 40" | 101 cm |
| Draft (Zeus) | 46" | 117 cm |
| Dry weight w/standard I/O engines | 19,933 lbs | 9,041 kg |
| Dry weight | 20,500 lbs | 9,299 kg |
| Dry weight (Zeus) | 24,600 lbs | 11,158 kg |
| Fuel capacity | 250 gal | 946 L |
| Water capacity | 55 gal | 208 L |
| Holding tank | 35 gal | 132 L |
| Dead rise | 21° | 21° |

The specification measurements are approximations and subject to variance.

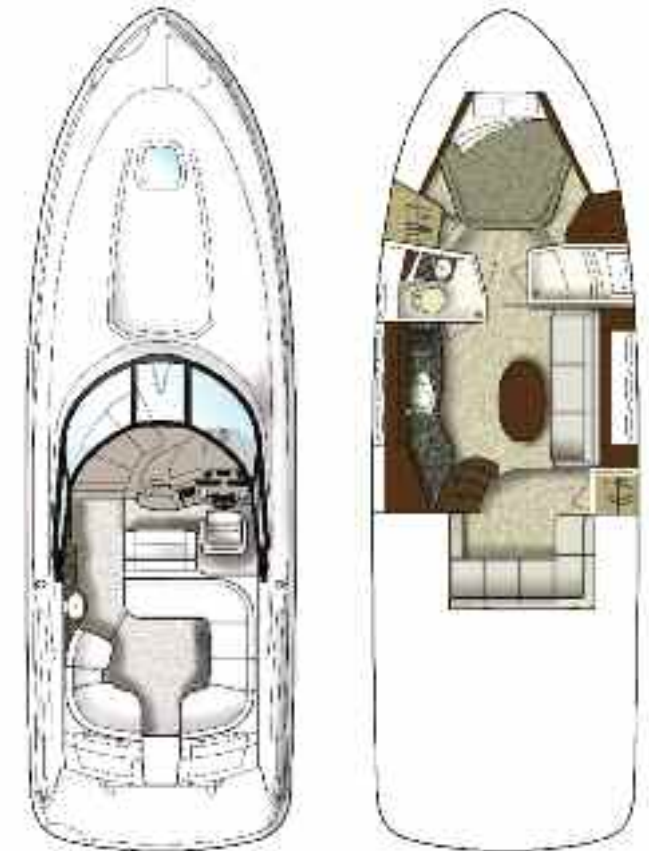

Cockpit Layout

Cabin Layout